

1 HR FR FIRE BOUNDARY

107173

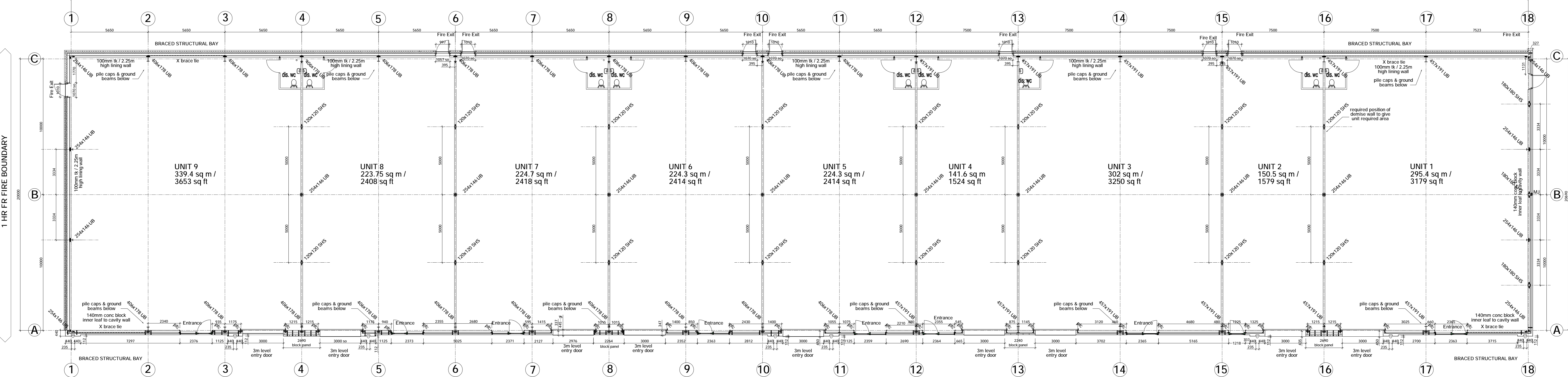

PLAN OF UNITS 1 - 9

SCHEDULE OF ACCOMMODATION			
GROSS INTERNAL AREAS		GROSS EXTERNAL AREAS	
BLOCK A	m ²	sq ft	PARKING
UNIT 1	295.4	3179.7	4 CARS
UNIT 2	150.5	1620	4 CARS
UNIT 3	302	3250.7	4 CARS
UNIT 4	141.6	1524.2	2 CARS
UNIT 5	224.3	2414.3	4 CARS
UNIT 6	224.3	2414.3	4 CARS
UNIT 7	224.7	2408.4	4 CARS
UNIT 8	223.75	2408.44	4 CARS
UNIT 9	339.4	3653.3	5 CARS
UNIT 10	393.8	4238.8	6 CARS
UNIT 11	393.8	4238.8	6 CARS
TOTAL	2124.95	22873.3	39 CARS
BLOCK B	m ²	sq ft	PARKING
UNIT 10	393.8	4238.8	6 CARS
UNIT 11	393.8	4238.8	6 CARS
TOTAL	787.6	8477.6	12 CARS

1 HR FR FIRE BOUNDARY

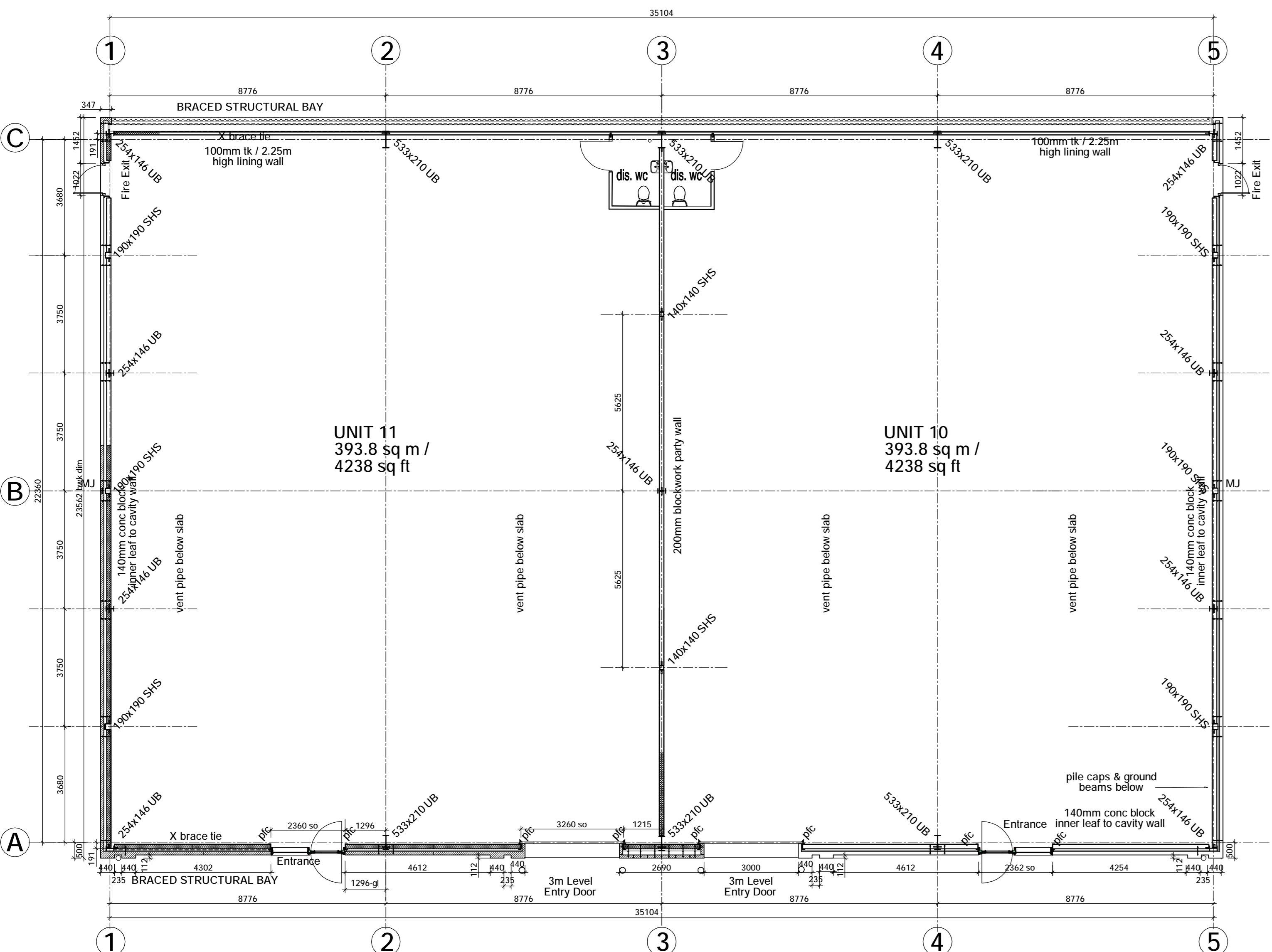

PLAN OF UNITS 10 & 11

- L 2-08-07 Plans re-aligned to ground of beam positions
- cross schedule updated
- K 31-07-07 Plans updated following receipt of info from Sir Eng & steel frame designers, grid lines amended, FE door positions updated, piles noted
- J 19-07-07 plans updated, grid lines moved positions of external FE doors to units 1, 2 & 3 changed
- I 24-5-07 plans updated positions of some external FE doors changed
- H 30-5-07 Schedule of Accommodation omitted "TENER ISSU" omitted
- G 24-5-07 plans updated area table revised end wall to unit 9 changed lining wall note changed
- Q 28-11-07 Dwc installations updated to as built site installations
- P 3-10-07 FE doors Units 1&11 relocated to brickwork gable ends masonry and frame ties added steel frames installations updated piles omitted for clarity
- F 09-5-07 plans updated area table revised
- E 20-2-07 fire boundary elevation noted
- D 20-2-07 Fire boundary conditions noted
- N 25-09-07 General plan updates
- C 20-10-06 Elevations and plans updated
- B 11-10-06 Elevations added
- M 15-08-07 Block B grid dimensions updated
- A 05-10-06 Updated to clients comments

aja

ALAN JOHNSON ASSOCIATES

1170 Elliott Court, Herald Avenue
Coventry Business Park Coventry CV5 6UR
Tel: 024 7625 3200 Fax: 024 7625 3210
e-mail: aja@aja-architects.com

project

**Proposed Redevelopment
Wetmore Maltings
Wetmore Road
Burton on Trent**

client

**Hillarys Developments
(No 5) LLP**

drawing

**NEW B1/2 UNITS
UNITS 1 - 9 & 10 - 11
PROPOSED PLANS**

scale 1:100 @ A0 drawn ajt

checked date rev D6